

Classroom Procedures

1. Entering Class Procedures

Conversation: Level 1

Help: Ask 3 before me

Activity: Grab your sketchbook bin and bring it to your desk.
Place your backpack in the “Backpack Parking Zone”.

Take out your drawing utensil(s).

Movement: Materials Cart

Participation: Preparing for Class

Sound: Instructor’s Music

2. Beginning of Class Procedures

Conversation: Level -0

Help: Raise your Hand

Activity: Warm-up, Free-Draw, Agenda

Movement: Materials Cart

Participation: Drawing and Writing

Sound: Instructor’s Music

3. Instructional Procedures

Conversation: Level -0

Help: Raise your Hand

Activity: Receiving Instruction

Movement: None

Participation: Listening, Drawing &/or Writing

Sound: None

4. Independent Procedures

Conversation: Level -1

Help: Ask 3 Before Me

Activity: Independent Work

Movement: Materials Cart and Restroom

Participation: Drawing/ Reading/ Writing

Sound: Instructor’s Music

Directions: In your student planner, write the agenda from below.

W.A.P. S. Week 2
Mon. 1-13-25

Essential Question: What is proportion and why is it important for portraiture?

What will I learn :

Standard VA.68.C.1.1: Use knowledge of the elements and principles of art to create works of art that are visually effective.

- **Application in Lesson:** Students will use their understanding of elements like line, shape, value, and texture to create a portrait that integrates realistic and abstract styles through stippling.

How I will learn it? (Agenda)

-Upload 5 Sub Drawings

-Continue Stippling Project

How do I know I learned it?

When I can score at least a 3 on the scale

4	I can correctly complete this activity innovatively.
3	I can correctly complete this activity independently
2	I can correctly complete this activity using peers assistance
1	I can correctly complete this activity using teacher assistance

Reminders:

-Find assignment info on katundra.com

-Submit assignments on Artsonia

****12/20 Friday Make-up Window Closes for Q2**

Grading Schedule:

Monday 1st and 2nd per

Tuesday 3rd and 5th

Wednesday 6th and 7th

Directions: In your student planner, write the agenda from below.

W.A.P. S. Week 2
Tues. 1-14-25

Essential Question: What is proportion and why is it important for portraiture?

What will I learn :

Standard VA.68.C.1.1: Use knowledge of the elements and principles of art to create works of art that are visually effective.

- **Application in Lesson:** Students will use their understanding of elements like line, shape, value, and texture to create a portrait that integrates realistic and abstract styles through stippling.

How I will learn it? (Agenda)

-Continue Stippling Project

Due Fri. 24

How do I know I learned it?

When I can score at least a 3 on the scale

4	I can correctly complete this activity innovatively.
3	I can correctly complete this activity independently
2	I can correctly complete this activity using peers assistance
1	I can correctly complete this activity using teacher assistance

Reminders:

-Find assignment info on katundra.com

-Submit assignments on Artsonia

****12/20 Friday Make-up Window Closes for Q2**

Grading Schedule:

Monday 1st and 2nd per

Tuesday 3rd and 5th

Wednesday 6th and 7th

Directions: In your student planner, write the agenda from below.

W.A.P. S. Week 2
Wed. 1-15-25

Essential Question: What is proportion and why is it important for portraiture?

What will I learn :

Standard VA.68.C.1.1: Use knowledge of the elements and principles of art to create works of art that are visually effective.

- **Application in Lesson:** Students will use their understanding of elements like line, shape, value, and texture to create a portrait that integrates realistic and abstract styles through stippling.

How I will learn it? (Agenda)

-Continue Stippling Project

Due Fri. 24

How do I know I learned it?

When I can score at least a 3 on the scale

4	I can correctly complete this activity innovatively.
3	I can correctly complete this activity independently
2	I can correctly complete this activity using peers assistance
1	I can correctly complete this activity using teacher assistance

Reminders:

-Find assignment info on katundra.com

-Submit assignments on Artsonia

****12/20 Friday Make-up Window Closes for Q2**

Grading Schedule:

Monday 1st and 2nd per

Tuesday 3rd and 5th

Wednesday 6th and 7th

Directions: In your student planner, write the agenda from below.

W.A.P. S. Week 2
Thurs. 1-16-25

Essential Question: What is proportion and why is it important for portraiture?

What will I learn :

Standard VA.68.C.1.1: Use knowledge of the elements and principles of art to create works of art that are visually effective.

- **Application in Lesson:** Students will use their understanding of elements like line, shape, value, and texture to create a portrait that integrates realistic and abstract styles through stippling.

How I will learn it? (Agenda)

-Continue Stippling Project

Due Fri. 24

How do I know I learned it?

When I can score at least a 3 on the scale

4	I can correctly complete this activity innovatively.
3	I can correctly complete this activity independently
2	I can correctly complete this activity using peers assistance
1	I can correctly complete this activity using teacher assistance

Reminders:

-Find assignment info on katundra.com

-Submit assignments on Artsonia

****12/20 Friday Make-up Window Closes for Q2**

Grading Schedule:

Monday 1st and 2nd per

Tuesday 3rd and 5th

Wednesday 6th and 7th

Directions: In your student planner, write the agenda from below.

W.A.P. S. Week 2
Fri. 1-17-25

Essential Question: What is proportion and why is it important for portraiture?

What will I learn :

Standard VA.68.C.1.1: Use knowledge of the elements and principles of art to create works of art that are visually effective.

- **Application in Lesson:** Students will use their understanding of elements like line, shape, value, and texture to create a portrait that integrates realistic and abstract styles through stippling.

How I will learn it? (Agenda)

-Continue Stippling Project

Due Fri. 24

How do I know I learned it?

When I can score at least a 3 on the scale

4	I can correctly complete this activity innovatively.
3	I can correctly complete this activity independently
2	I can correctly complete this activity using peers assistance
1	I can correctly complete this activity using teacher assistance

Reminders:

-Find assignment info on katundra.com

-Submit assignments on Artsonia

****12/20 Friday Make-up Window Closes for Q2**

Grading Schedule:

Monday 1st and 2nd per

Tuesday 3rd and 5th

Wednesday 6th and 7th

Abstract Realism Stipple Portrait



Florida Visual Arts Standards

Critical Thinking and Reflection

VA.68.C.1.1: Apply a range of interests and contextual connections to influence the creative process in art-making.

Skills, Techniques, and Processes

VA.68.S.3.3: Use various observational drawing techniques to refine accuracy and detail.

Organizational Structure

VA.68.O.1.1: Identify and use structural elements of art and organizational principles of design to support planning and production of artwork.

Innovation, Technology, and the Future

VA.68.F.1.2: Use an online resource to upload and present artwork as part of a digital portfolio (e.g., Artsonia).

Historical and Global Connections

VA.68.H.3.3: Create imaginative works to reflect specific cultural or historical ideas.

Creative Expression

VA.68.S.2.1: Organize the structural elements of art to support creative goals.

VA.68.S.2.3: Use visual-thinking and problem-solving skills in a sketchbook or journal to document the creative process.

Objective: Students will create a portrait that combines realism and abstraction using stippling, learning to balance contrasting artistic styles while developing patience and precision.

Summary: In this project, you'll create a unique portrait that combines realism and abstraction using the stippling technique. First, choose a person to draw (like yourself or someone you admire) and create a light grid on your paper and reference image to help sketch the face accurately. Divide the portrait in half—one side will be realistic, where you'll carefully draw and stipple the details of the face using dots to create shadows and highlights. On the other side, you'll design an abstract composition with creative shapes, patterns, and textures that express your personality or ideas. Blend the two sides together in a way that feels natural or dramatic, depending on your style. The final artwork should be completed in ink, and adding color is an option to enhance your design. Finally, upload your finished work to Artsonia and share your artistic statement to explain your creative choices!

Abstract Realism Stipple Portrait Checklist:

Planning & Preparation

- Choose a subject for your portrait (self-portrait, family member, or someone you admire).
- Find or take a clear reference image of your subject.
- Lightly draw a grid on your paper and your reference image to help with accuracy.

Realistic Side

- Divide your paper to separate the realistic and abstract sides.
- Use the grid to carefully sketch the realistic features of the face on one side.
- Add stippling (dots) to create shadows, highlights, and texture.
- Use dense dots for dark areas and spaced-out dots for lighter areas.

****You should have the above portion completed for the midterm.****

Abstract Side

- Brainstorm patterns, shapes, and lines for your abstract design.
- Sketch your abstract design lightly in pencil on the other side of the portrait.
- Use stippling to create value, texture, and depth in your abstract design.
- Blend or transition the realistic and abstract sides creatively.

Finalizing the Portrait

- Go over your final design with ink for clean and bold details.
- Add color if desired to enhance your composition.
- Erase all visible pencil marks once the ink is dry.
- Check for balance between the realistic and abstract sides.

Submitting Your Artwork

- Take a clear, well-lit photo of your finished portrait.
- Upload your artwork to Artsonia using the class code.
- Write an artist statement explaining your creative choices and process.

Reflection

- Review your work: Did you balance realism and abstraction?
- Participate in the class critique or gallery walk.
- Write a short reflection on what you enjoyed and learned in this project.

Abstract Realism Stipple Portrait Rubric

Criteria	4 - Excellent	3 - Proficient	2 - Developing	1 - Needs Improvement
Realistic Side	Features are highly accurate, detailed, and well-proportioned; stippling creates clear depth and value.	Features are mostly accurate and proportionate; stippling shows good depth and value.	Features are somewhat accurate but lack proportion; stippling shows limited depth or value.	Features are inaccurate or incomplete; stippling lacks depth or is not applied effectively.
Abstract Side	Abstract design is creative, well-balanced, and clearly integrates personal or symbolic elements.	Abstract design is visually interesting, mostly balanced, and includes some personal elements.	Abstract design lacks balance or creativity; personal elements are unclear or missing.	Abstract design appears rushed, lacks effort, or does not reflect abstract principles.
Blending of Styles	Realistic and abstract sides transition seamlessly with thoughtful integration.	Realistic and abstract sides connect well with minor inconsistencies in transition.	Minimal blending between realistic and abstract sides; transition is unclear.	No attempt to blend realistic and abstract sides; they appear disconnected.
Use of Stippling	Stippling is applied consistently and effectively to create a wide range of values and textures.	Stippling is mostly consistent and shows a good range of values and textures.	Stippling is uneven or inconsistent, with limited variation in value or texture.	Little or no use of stippling, or technique is not evident in the artwork.
Ink and Color Application	Ink is applied cleanly and enhances the design; color (if used) is thoughtful and well-executed.	Ink is mostly neat and supports the design; color (if used) is applied with some intention.	Ink is uneven or messy; color (if used) lacks intention or does not enhance the design.	Ink is incomplete or messy; no attempt to use color thoughtfully (if required).

Reflection Questions:

1. Why did you choose this person as the subject of your portrait? How do they inspire or connect to you personally?
2. How did you decide on the patterns, shapes, and designs for your abstract side?
3. What techniques did you use to create depth and texture with stippling? How did you ensure contrast between light and dark areas?
4. How do you feel about the balance between the realistic and abstract sides of your portrait? If you could make any changes to your work, what would they be and why?
5. According to the rubric what would be your grade?

Step 1: Plan and Sketch Your Portrait Day 1 of 2

1. **Choose Your Subject:** Decide whose portrait you want to create—it can be yourself, a family member, or someone you admire. It has to be a person
2. **Divide the Portrait in Half:** Lightly draw a vertical line down the middle of your paper.
3. **Realistic Side:** On one half, sketch the face as realistically as possible, paying attention to details like eyes, nose, mouth, and shading areas.
4. **Leave Space for Transition:** Plan how you will connect the realistic side to the abstract side with a smooth or creative blend.
5. **Plan the Transition:** Sketch how the realistic and abstract parts will meet—blend smoothly or create a bold contrast.

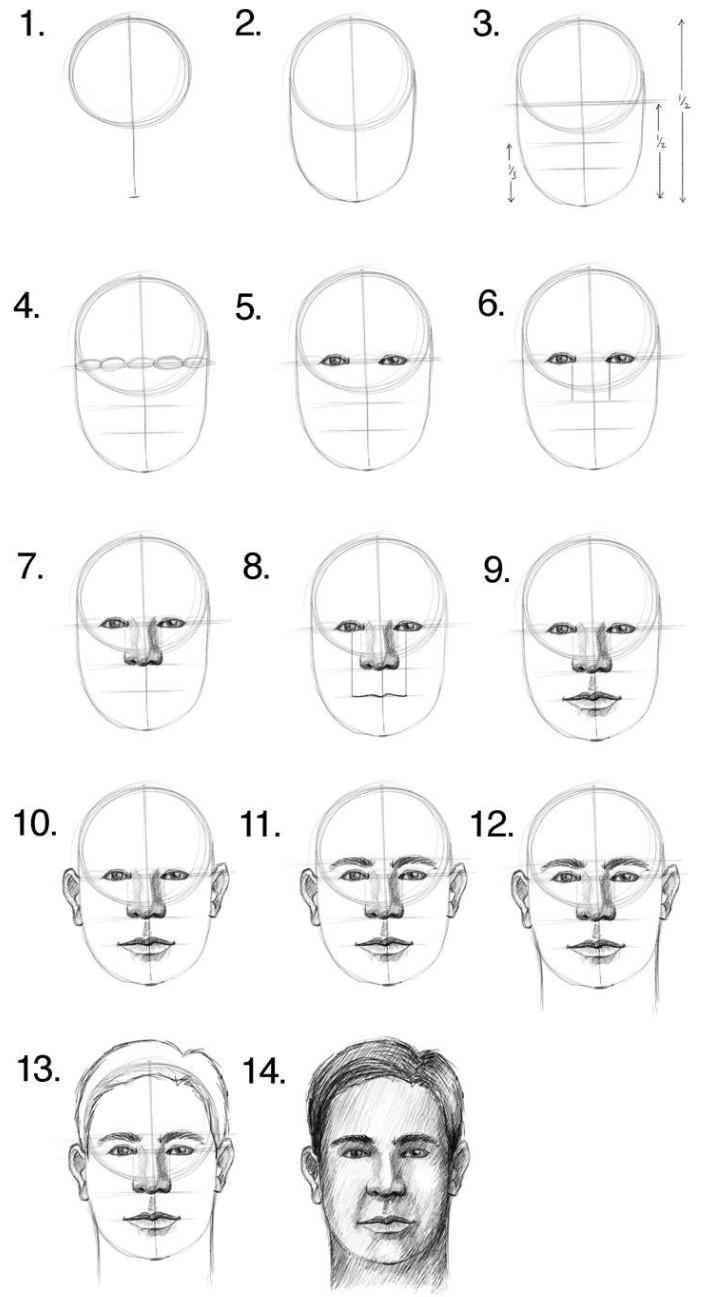
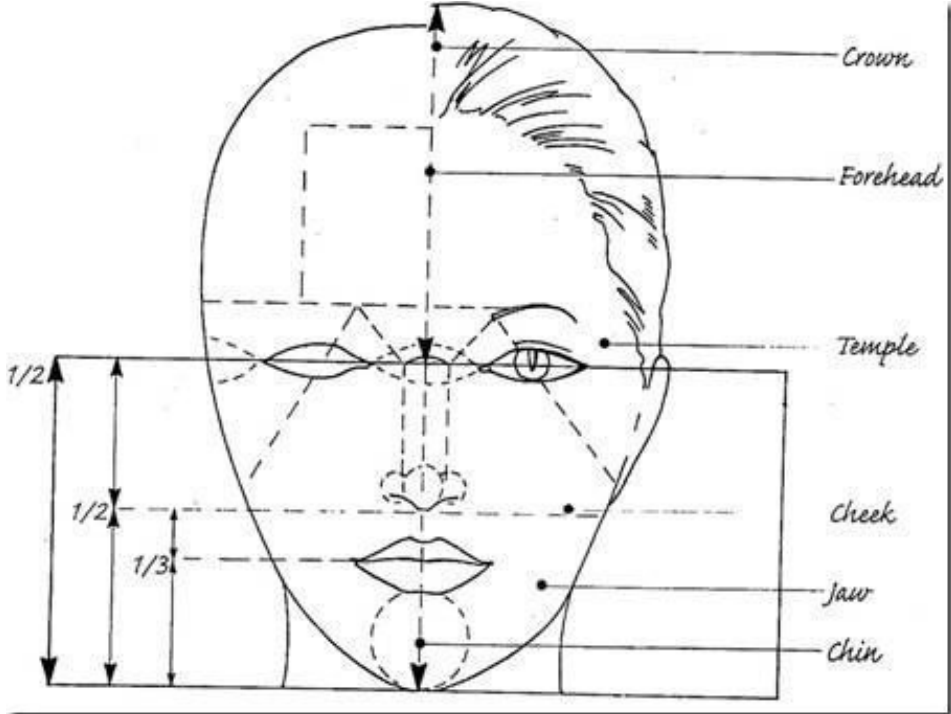

Abstract Realism Stipple Portrait

Step 1: Create a 8 by 10 Grid

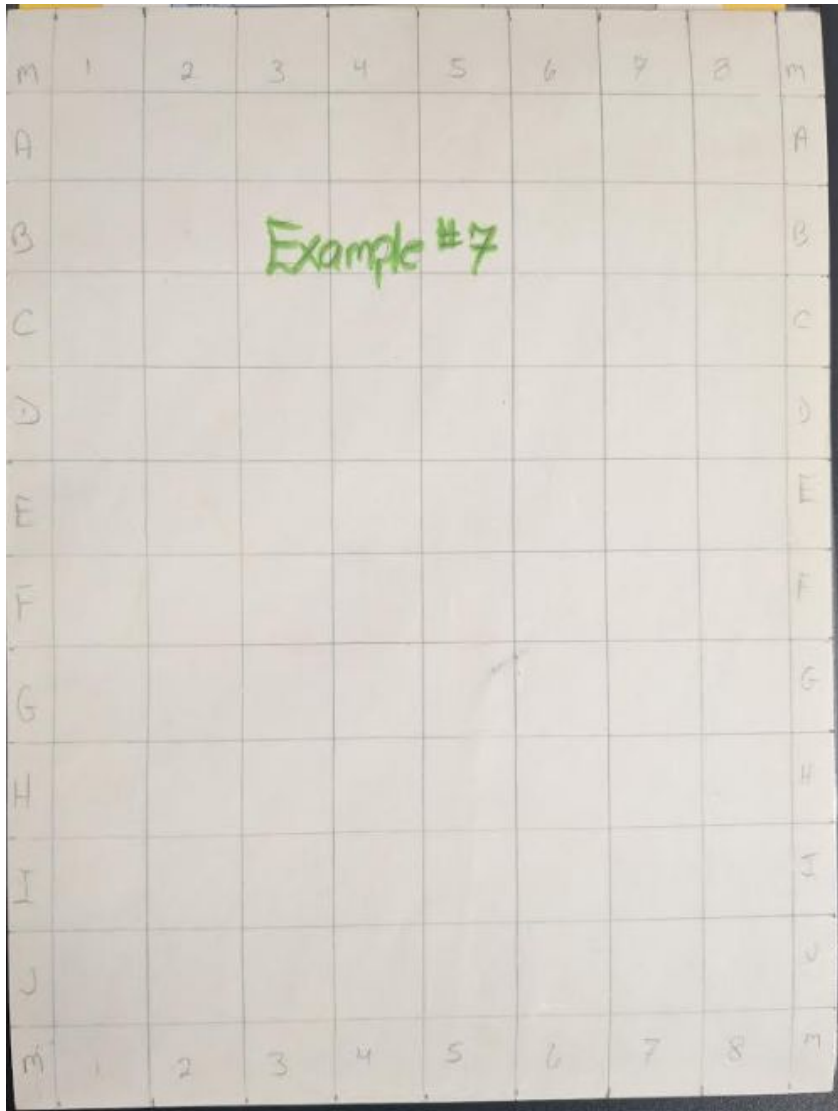

Step 2: Use the reference to draw the contour (outline) of your subject.

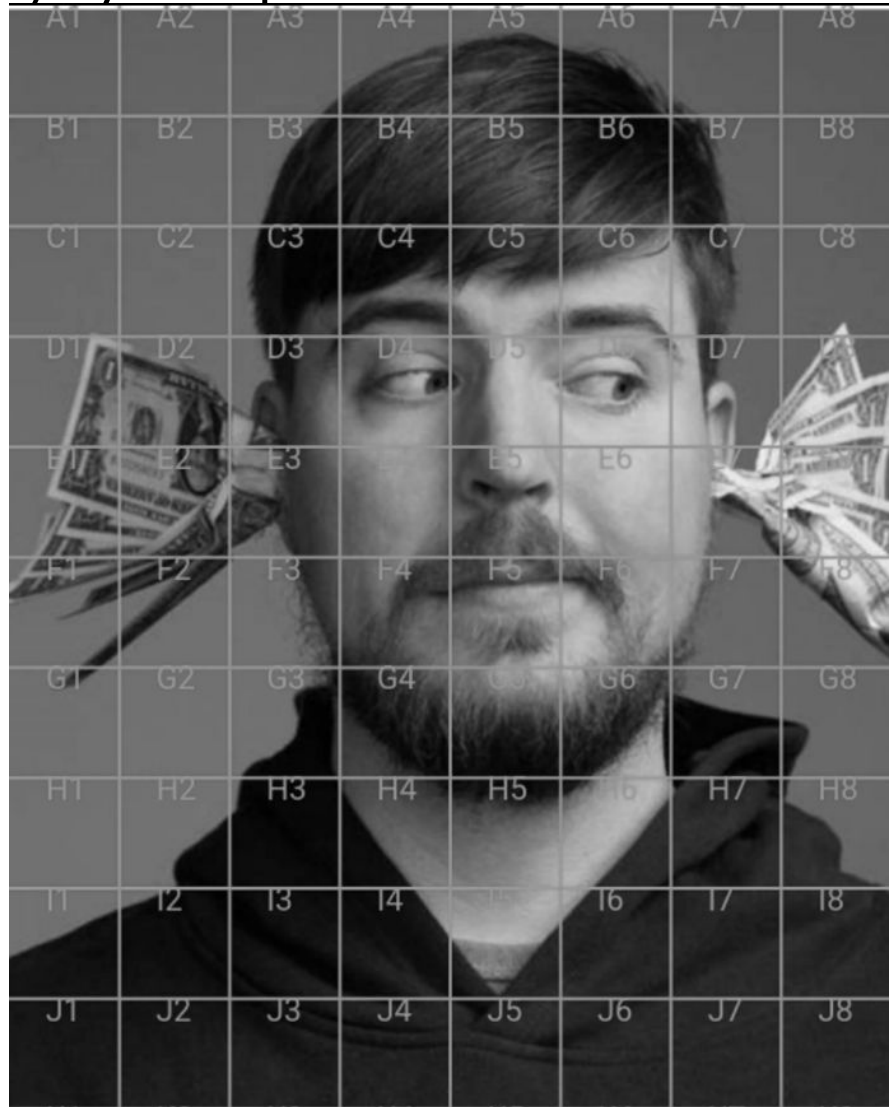



FIND
LOVE
PEACE
HOPE

"Come join us at First Priority! Let's grow together as a community that encourages one another and lets our light shine. Whether you're looking for a place to connect, share your faith, or just explore what it means to live with purpose, First Priority is a welcoming space for everyone. Let's build each other up and make a positive impact! See you there!"

Every: Friday @ 8:15-8:45

am

Where: Gym

Last Week

1st-78	1st-77
D=6	D=7
F=1	F=2
2nd-75	2nd-72
D=2	D=2
F=6	F=7
3rd-74%	3rd-73%
D=1	D=3
F=7	F=5
5th-81%	5th-82%
D=3	D=2
F=3	F=3
6th-82%	6th-81%
D=2	D=1
F=2	F=4
7th-73%	7th-76%
D=5	D=6
F=5	F=3

Today is Data Day which is a day to ask questions about your grade. And submit missing work.

1. Make sure you submit the following assignments today because the window will close at the end of class. If you don't make it then you'll need to submit it to the Make-Up Window. Each student will have the iPad for 10 minutes to submit the work.

WK 8_Bellwork

WK 8_Sub Drawing

WK 8_InProgress Portrait Drawing

2. Check Grade in FOCUS and Submit Your Missing Assignments in Artsonia under **Make-Up Work** for partial credit
You need to type the date and name of the assignment, as it appears in FOCUS. This will help me to place the grade under the appropriate assignment.
IF you have a question about the assignment check it on katundra.com
next,
3. Free Draw

Upload Your Work to Artsonia

1. Either Download the Artsonia App on your phone or Use the Web Browser and type in Artsonia.com
2. Click on ARTIST
3. Click on Class Portal
4. Type in the **School ID:** **Odyssey19** Access Code **JPPT-BWDB**
(If you don't have an account click on Add my name> complete the sections, including the full last name, the class is your period)
5. Click on All Students
6. Enter Your Name
7. Add Art
8. Select the name of the assignment:
9. Take a Picture
10. Crop the image if needed
11. Title the work
12. Type the Artist Statement
13. Submit to Teacher

6. *Clean-Up Procedures*

Conversation: Level -1

Help: Ask 3 Before Me

Activity: *Art Organizer* - provide guidance for work, *Materials manager*- make sure materials are put away in the appropriate location, *Sketchbook Supervisor*- switch out the sketchbook holder for the next period, *Waste Watchdog* - make sure the table and floor is clean.

Movement: Materials Zone and Backpack Zone

Participation: Cleaning

Sound: None

*** Please be aware that failing to adhere to the above will result in completing a behavior sheet.**